

**neat**

# USER GUIDE



**DOOR**  
DOOR ALARM

## Contents

Important Information .....	3
Overview .....	4-5
Installation.....	6
Mounting Instructions .....	7
External Sensor - Wiring.....	7
Functionality .....	7
Alarm Delay at In Passage .....	8
Alarm Delay at Out Passage .....	8
Configuration .....	8
Special Functions.....	9
Connect DOOR to Portable Receiver TREX .....	10
Connect DOOR to Home Care Phone NEO .....	10
Declaration of Conformity .....	11

## Important Information



Always treat your product with care. Only NEAT Electronics authorized personnel should perform service.



Do not expose your product to open flames, lit tobacco products or temperatures above 60°C.



This symbol on the product or on its packaging indicates that this product shall not be treated as household waste. Instead it shall be returned to NEAT Electronics for recycling. The recycling of materials will prevent negative consequences for the environment, human health and help to conserve natural resources.

## Overview

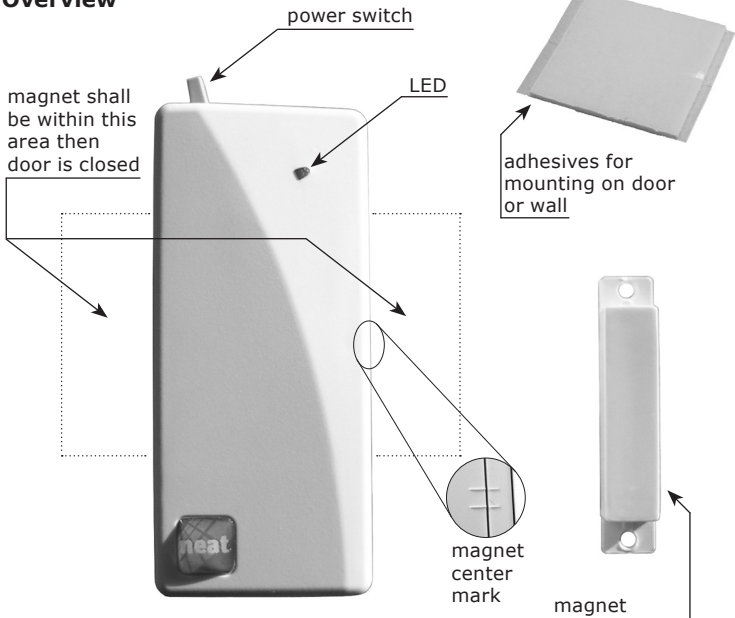

## Overview

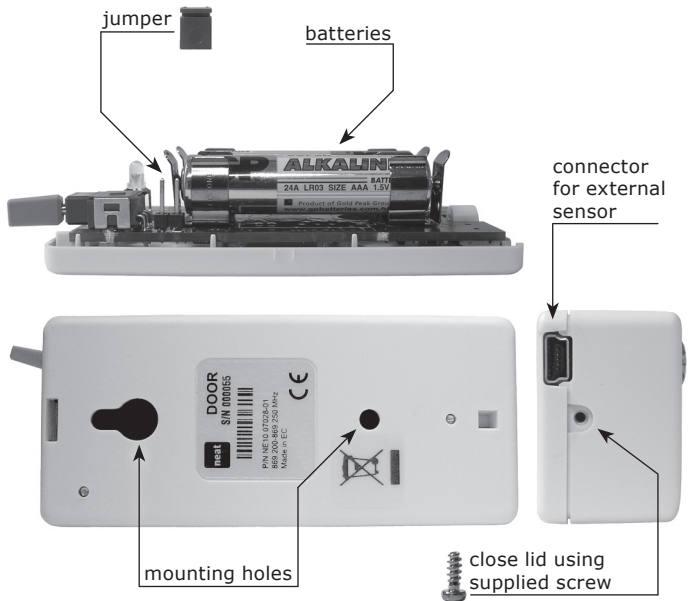

## Installation

1. Open the cover and insert two batteries of type AAA (LR03).
2. To enable *in passage delay* and *out passage delay*, remove the jumper from the circuit board and place it over both pins as shown on page 8.
3. Close the cover and fit the screw as shown on page 5.  
Mount the door alarm as described on the next page.
4. If an external sensor shall be used, such as a a bed alarm or a carpet sensor, insert the cable from the sensor to the connector on the botton short side of the door alarm.
5. Turn on the power switch.
6. Connect the door alarm to an alarm receiver as described on page 10 in this manual.

## Mounting Instructions

The door alarm can be mounted on a door and the magnet on the door frame, or vice versa. The magnet can be placed on either side of the door alarm.

The distance between door alarm and magnet must not be more than one centimeter when the door is closed. If the door is made from metal, an even shorter distance between door alarm and magnet may be necessary.



## External Sensor - Wiring

alarm sensor

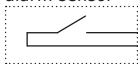

pin 5: ground

pin 4: sensor input

DOOR

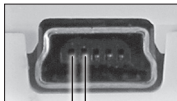

## Functionality

DOOR sends a radio alarm as soon as the door is opened. A new alarm is not sent until the door has been closed and is opened a second time.

When an alarm is transmitted, the LED on DOOR lights up with a steady red light during up to four seconds. If DOOR receives an acknowledgement from an alarm receiver, the LED on DOOR changes color to green and stays lit for another two seconds.

**Note:** If the *in passage delay* is enabled, the LED first blinks during five seconds before an alarm is transmitted.

## In Passage Delay

If the *in passage delay* is enabled, DOOR waits five seconds before sending an alarm when the door is opened. During this time, the LED on DOOR blinks with red light. If the power switch is turned off when the LED is blinking, no alarm will be sent.

This way, care personnel can enter the room without an alarm being sent. When care personnel leaves the room the power switch must be turned on again.

## Out Passage Delay

If the *out passage delay* is enabled, DOOR does not react to the door being opened during the first five seconds after the power switch on DOOR is turned on. This allows care personnel to leave the room without an alarm being sent.

## Configuration

The in- and out passage delay can be enabled by fitting the jumper on the circuit board inside DOOR over both pins.

To change other settings, a computer with the DOOR configuration software must be used.

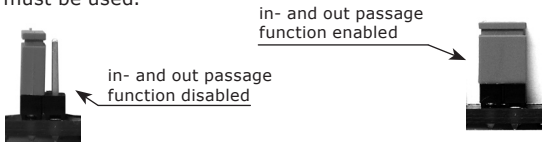

**Note:** The *in passage* and *out passage* delay do not apply to the external sensor.



## Special Functions

The functions described on this page must be activated using a computer and the DOOR configuration software. It is also possible to order DOOR with these functions activated.

### Auto Reset Timeout

It is possible to configure DOOR with an *auto reset* timeout for the external alarm sensor. When the external sensor is activated, DOOR waits during the *auto reset* time before sending an alarm. If the alarm sensor is activated a shorter time than the auto reset time, no alarm will be sent.

This function is useful for example with a bed sensor connected to DOOR. The patient can then go to the toilet without an alarm being sent as long as he returns to bed within a certain time.

### Peek Function

With a carpet sensor connected to DOOR and the *peek function* enabled, the door can be opened without any alarm being sent as long as the patient is standing on the door mat.

Combining the *peek function* and the *auto reset* timeout gives the patient the possibility to go out and fetch the newspaper without an alarm being sent, as long as he returns to the room and closes the door from the inside within a certain time.

## Connecting DOOR to Portable Receiver TREX

To program a TREX to receive alarms from DOOR, perform the following steps:

1. Choose *Programming* and then *Add transmitter* from the menu in the TREX.
2. Open the door that the door alarm is mounted on.
3. The LED on DOOR lights up with a steady red light to indicate that the radio code is transmitted. The TREX beeps to indicate that a radio code is received.
4. Choose an alarm text, an alarm number and the equipment type door alarm in the TREX.

## Connecting DOOR to Home Care Phone NEO

Receiver position 5 in NEO is standard for door alarms. To program alarms from DOOR into position 5 in NEO, perform the following steps:

1. Press and hold the grey button on NEO while switching NEO on.
2. Wait until five beeps are heard, then release the button.
3. Open the door that the door alarm is mounted on.
4. The LED on DOOR lights up with a steady red light to indicate that the radio code is transmitted, then possibly turns green for two seconds. The home care phone sounds to indicate that the radio code from DOOR is stored.

**Note:** If the *in passage delay* is enabled, the LED first blinks during five seconds before an alarm is transmitted.

## Declaration of Conformity

We NEAT Electronics AB, Varuvägen 2, 246 42 Löddeköpinge, declare under our sole responsibility that our product DOOR, NE10 07028-01, is in conformity with the directives 1999/5/CE, 73/23/CE and 89/336/CEE and conforms to the standards:

Safety: EN 60950-1:2001  
EMC: EN 301489-3 v1.4.1 Class I  
Radio: EN 300220-3 v1.1.1

Löddeköpinge, February 2008



Lars Nyström  
Managing director NEAT Electronics AB



[www.neatelectronics.com](http://www.neatelectronics.com)

NEAT Electronics AB  
Varuvägen 2  
246 42 Löddeköpinge  
SWEDEN